



Address 2035 27th St SW, Calgary AB
Date May 18th, 2023
Name Susan Penley | Remax Real Estate (Central)
Email team@calgaryexperts.com
Phone 403.660.9249

FLOOR TOTALS

Main Level	593.46 sqft / 55.13 m2	RMS Total	1154.67 sqft / 107.27 m2
Upper Level	561.21 sqft / 52.14 m2	Total w/ basement	1660.66 sqft / 154.28 m2
Basement Total	505.99 sqft / 47.01 m2	Order Procedure	RECA RMS
Finished Basement	269.53 sqft / 25.04 m2	Exterior Wall Size	NA
		Order Type	Attached Single Family



ROOM DIMENSIONS

Kitchen	12'6" X 11'0" ft/in	M	Deck	21'0" X 16'0" ft/in	M
Dining Area	12'4" X 8'6" ft/in	M	Garage	25'0" X 23'0" ft/in	M
Living Room	14'8" X 12'6" ft/in	M			
Foyer	4'8" X 4'2" ft/in	M			
Rec Room	15'8" X 12'0" ft/in	B			
Utilities w/Laundry	15'10" X 15'4" ft/in	B			

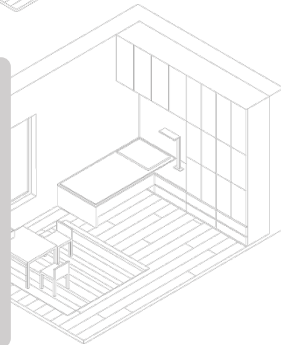

BEDROOM DIMENSIONS

Primary Bedroom	14'0" X 12'6" ft/in	U
Bedroom Two	12'6" X 10'10" ft/in	U

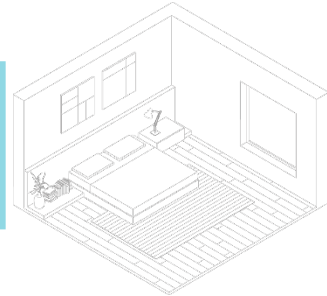

BATHROOM PIECES AND ADDITIONAL ROOMS

Two Piece	6'4" X 2'10" ft/in	M
Four Piece	9'4" X 8'8" ft/in	U

